

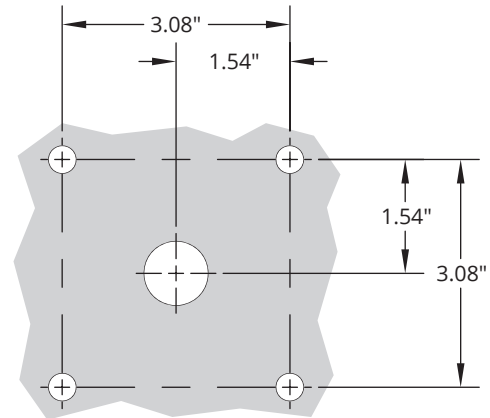

## SPECIFICATIONS

PHYSICAL	
Dimensions	5.80"(H) x 7.45"(W) x 5.25"(D)
Shipping Weight	5 lbs.
ELECTRICAL	
Input	9-12 VDC supplied by Wiegand controller
EQUIPMENT	
Reader	HID® ProxPoint® Plus or Secura Key dependent on model
ENVIRONMENTAL	
Operating Temperature	-15 to 150 °F

## MOUNTING (BACK OF UNIT SHOWN)



### HOLE SIZES

Wiring pass through	0.88"
Mounting holes (x4)	0.38"

*Unit includes mounting hardware.*

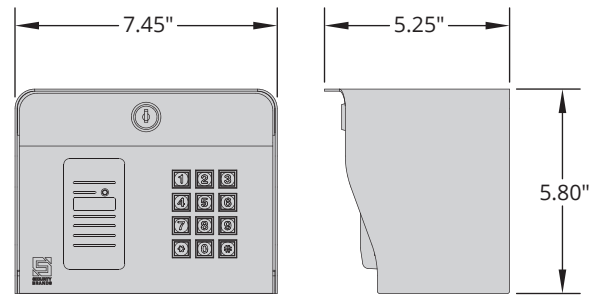

*Model 23-006KP*

## AVAILABLE MODELS (SEE PRICE GUIDE TO SEE ALL MODELS)



**23-006**  
Post Mount



**23-006I**  
Post Mount w/ Intercom



**23-006KP**  
Post Mount w/ Keypad